

Trunk Opener

Opener Switch Test/Replacement

1. Remove the driver's door panel (see [section 20](#)), then push the switch out of the door panel as shown.

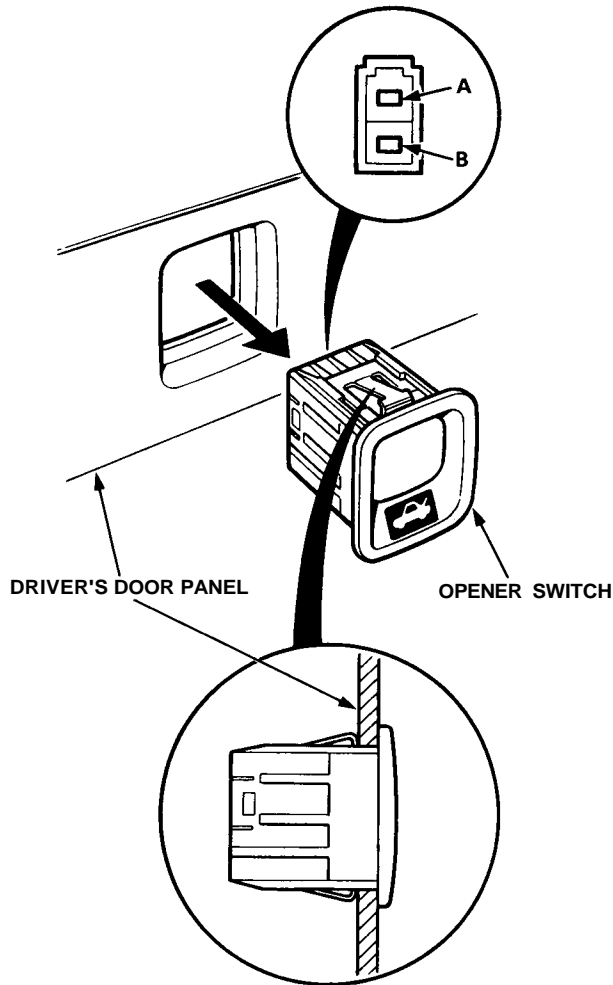

2. Check continuity between the A and B terminals.
 - There should be continuity when the switch is pushed.
 - There should be no continuity when the switch is released.
3. If necessary, replace the switch.

Solenoid Test/Replacement

1. Open the trunk lid and remove the trunk lid inner trim panel (see [section 20](#)).
2. Disconnect the 6-P connector from the solenoid.
3. Test the solenoid by momentarily connecting battery power to the C terminal and ground to the D terminal.

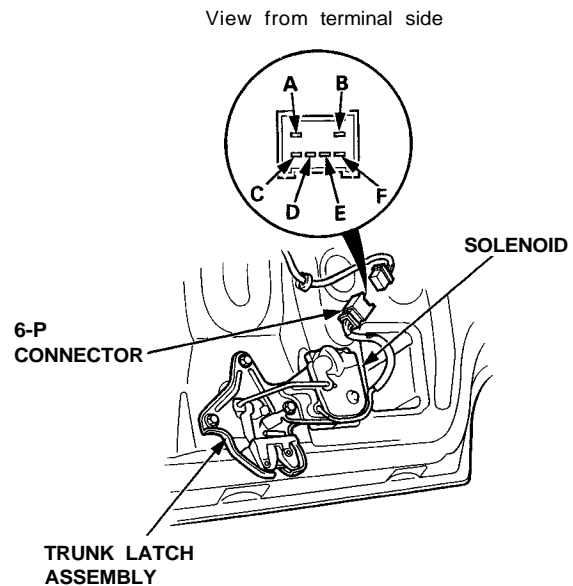

4. If the solenoid is faulty, remove the three mounting bolts from the trunk latch, and remove the trunk latch assembly.